

LIFT GUIDES

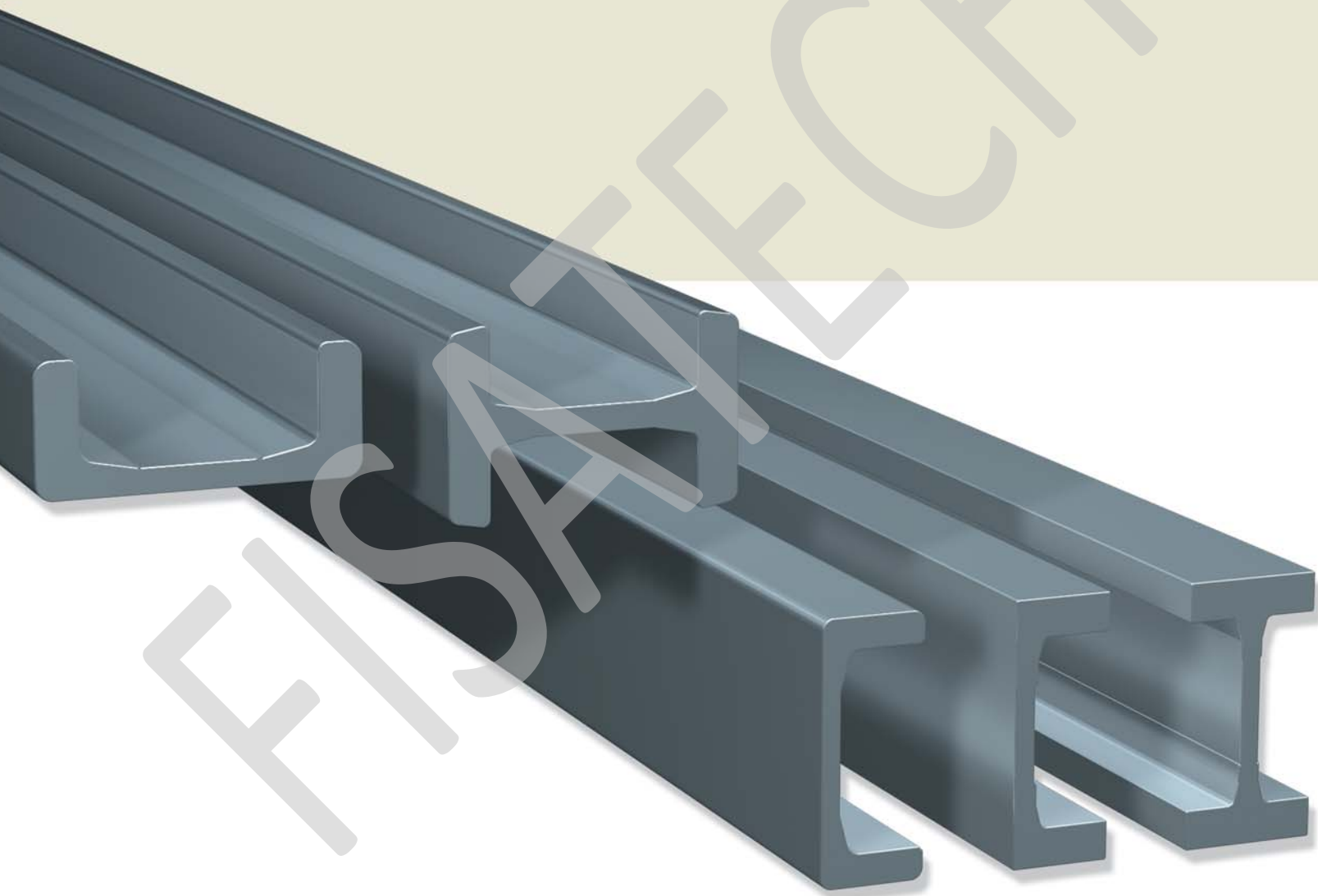

“U” STANDARD LIFT GUIDES

“U” standard lift guides are used in different industrial fields: fork lift masts, food industry, car industry, ceramic industry, machine tool industry.

Normally small and medium size combined bearings are used inside these guides.

They are manufactured in ST 52.3 steel.

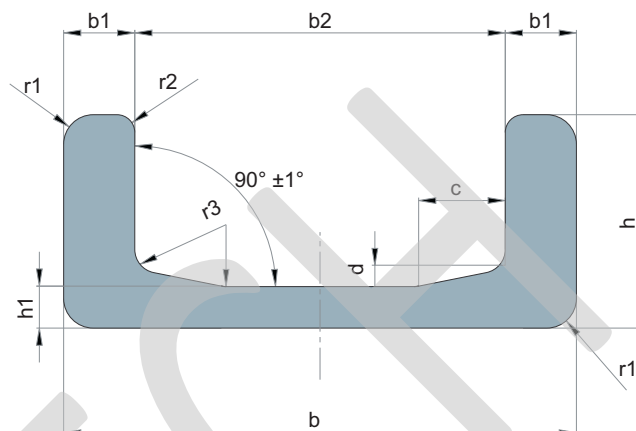

C.R. ref.	Dimensions														WEIGHT Wx	
	(b)	b1	Tol.	b2	Tol.	h	Tol.	h1	Tol.	c	d	r1	r2	r3	Kg/m	Cm ³
EC 053	65	6	±0,5	53	±0,4	30	±0,5	6	±0,5	4	4	6	4	*	5,3	11,9
2890	86,5	12	±0,5	62,5	+1	36	±0,8	7	±0,5	15	3	≤6	2-3	4	10,5	32
2867	103,2	16,2	±0,5	70,8	±0,5	40	±0,8	7,7	±0,5	15	3	≤6	2-3	5	14,8	53
2810	121,3	21,3	±0,5	78,7	±0,5	41	±0,8	10,8	±0,5	15	5	≤6	2-3	5	20,9	81
2811	135,4	23	±0,5	89,4	±0,5	53	±0,8	12,7	±0,5	15	5	≤6	2-3	5	28,6	128
2862	157,2	24,4	±0,5	108,4	±0,5	61,2	±0,8	14	±0,5	15	5	≤6	2-3	5	35,9	190
2891	175	25,6	±0,5	123,8	±0,5	66,2	±0,8	16,2	±0,5	15	5	≤6	2-3	5	42,9	250
2757	201,5	25,7	±0,5	150,1	±0,5	71,2	±0,8	19,4	±0,5	20	5	≤8	2-3	6	52,3	340

Material: UNI Fe 510 C – DIN St 52.3

The profiles can be cut on request of the customer, maximum length is 12 m.

“I” STANDARD LIFT GUIDES

Standard “I” profiles are exclusively used to build the fork lift masts.

The “I” profile has been realized in order to satisfy the needs of the manufacturers of fork lifts.

The combined bearings are used inside these profiles, like in the case of the “U” profiles.

They are manufactured in ST 52.3 steel.

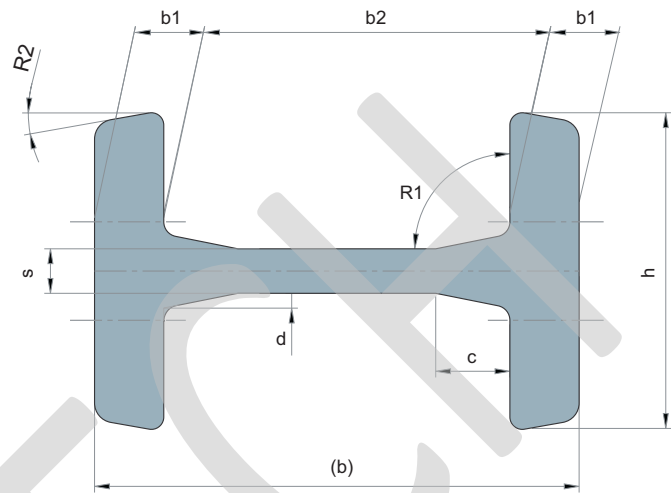

C.R. ref.	Dimensions												WEIGHT W_x		
	(b)	b_1	Tol.	b_2	Tol.	h	Tol.	s	Tol.	c	d	R_1	R_2	Kg/m	Cm^3
3018	98	14	$\pm 0,5$	70	+1	65	± 1	9	$\pm 0,5$	15	3	$91^\circ+1^\circ$	10°	19,4	70
3019	113,9	18	$\pm 0,5$	77,9	+1	66	± 1	11	$\pm 0,5$	15	3	$91^\circ+1^\circ$	10°	25,3	102
3275	129,6	20,5	$\pm 0,5$	88,6	+1	72	$\pm 1,25$	12	$\pm 0,5$	15	3	$91^\circ+1^\circ$	10°	31,2	143
3020	129,6	20,5	$\pm 0,5$	88,6	+1	81	$\pm 1,25$	12	$\pm 0,5$	15	3	$91^\circ+1^\circ$	10°	34,1	160
2912	140,2	18,96	$\pm 0,8$	102,28	-0,8	69,9	+1,60	12,7	$\pm 0,5$	*	*	*	*	31,2	157
3100	152,4	22	$\pm 0,5$	108,4	$\pm 0,5$	83	± 1	14	$\pm 0,5$	20	3	$91^\circ+1^\circ$	12°	40,8	219
3353	175	25,6	$\pm 0,5$	123,8	$\pm 0,5$	90	$\pm 1,3$	15	$\pm 0,5$	20	5	$91^\circ+1^\circ$	5°	51,4	322

Material: UNI Fe 510 C – DIN St 52.3

The profiles can be cut on request of the customer, maximum length is 12 m.

“U” PRECISION LIFT GUIDES

“U” precision lift guides are obtained from “U” standard lift guides.

They are processed by a machine tool in order to have a high level of processing with extremely limited tolerances.

Used with “DR” special combined bearings inside, they represent a very good alternative to the linear guide system.

They are made of ST 52.3 steel.

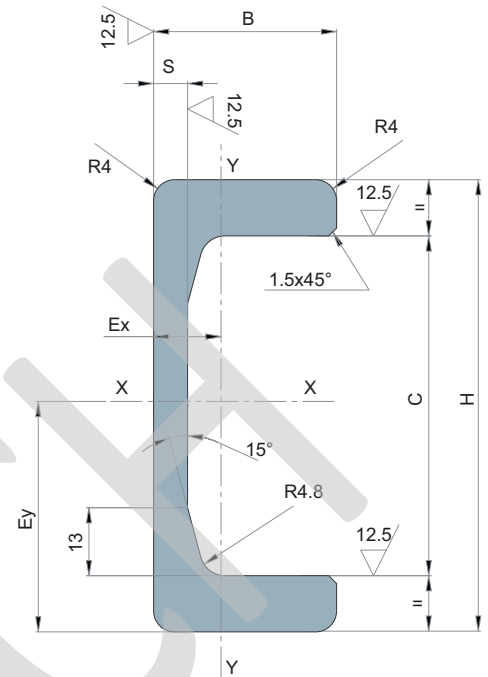

C.R. ref.	Dimensions				Moments of Inertia		Modulus of Resistance		WEIGHT Kg/m	Ex mm	Ey mm
	C	H	B	S	Jx Cm ⁴	Jy Cm ⁴	Wx Cm ³	Wy Cm ³			
EC 065 L	65	86,5	35	6,5	125,1	12,9	28,9	10,7	9,44	12,09	43,25
EC 074 L	74	103	39	7	248,9	23,2	48,3	16,3	13,14	14,22	51,5
EC 082 L	82	121	39,2	9	439,1	30,3	73,4	21,4	17,87	14,44	60,5
EC 093 L	93	135,5	51	11	792	75	116,9	39,6	25,16	18,94	67,75
EC 112 L	112	157	59	12	1357,5	126,8	172,9	59,1	31,47	21,46	78,5
EC 128 L	128	175	64	14	1891,5	174,2	227,6	77,4	37,71	22	87
EC 154 L	154	201	69	17	3098,7	230,8	308,3	46	45,98	22,8	100,51

Material: UNI Fe 510 C – DIN St 52.3

The profiles can be cut on request of the customer, maximum length is 10 m.

“U” WELDED LIFT GUIDES

The “U” welded lift guides are obtained from the assembling of welded laminated plates.

They are used in heavy industry, in high load fork lift masts, in big size handling plants.

They are made of ST 52.3 steel.

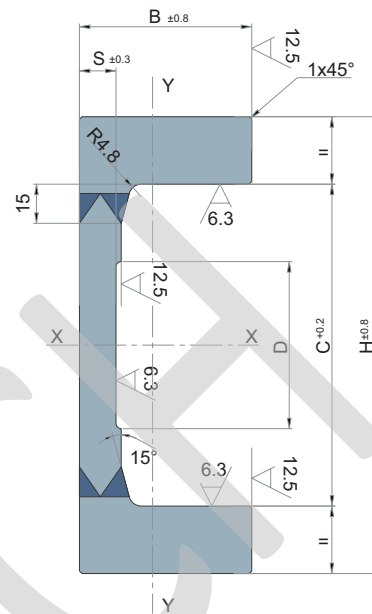

C.R. ref.	Nominal Capacity KN	Centre of Gravity mm	Dimensions					Moments of Inertia		Modulus of Resistance		WEIGHT Kg/m
			C	H	B	S	D	Jx Cm ⁴	Jy Cm ⁴	Wx Cm ³	Wy Cm ³	
FC 123 L	50	600	123,3	175	66	16	*	2181,6	206	249,3	86,7	42,37
FC 149 L	60	600	149,4	202	71,2	19,4	*	3480,6	276,5	344,6	114	52,31
FC 165	80	600	165,4	230	57,5	18	80	4410,5	174,6	383,5	87,5	53,3
FC 190	100	600	190,4	255	77	22	80	7631,6	434,2	598,6	167,7	73,7
FC 220	160	600	220,4	295	85	20	125	12632,7	6720,4	856,5	231,7	86,1
FC 250	200	600	250,4	344	94	26,5	125	23371,6	1117,4	1358,8	344,9	122,8

Material: UNI Fe 510 C – DIN St 52.3

The profiles can be cut on request of the customer, maximum length is 10 m.

“I” WELDED LIFT GUIDES

The “I” welded lift guides are obtained from the welding of laminated plates.

They are used in the same application fields as the “U” welded lift guides.

Jumbo series combined bearings are used inside these guides.

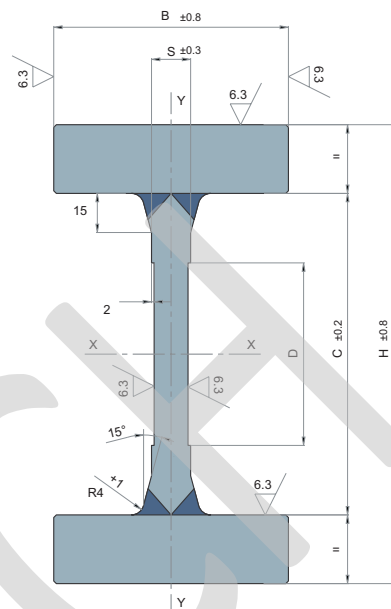

C.R. ref.	Nominal Capacity KN	Centre of Gravity mm	Dimensions					Moments of Inertia		Modulus of Resistance		WEIGHT Kg/m
			C	H	B	S	D	Jx Cm ⁴	Jy Cm ⁴	Wx Cm ³	Wy Cm ³	
FI 123	60	800	123,3	176	90	15	*	2960	325	336	72	52,8
FI 149	80	800	149,3	205	110	16	*	5320	615	519	112	68,7
FM 165	100	600	165,4	230	95	16	80	6825	475	593	100	71
FM 190	160	600	190,4	255	130	20	80	11983	1203	940	185	100
FM 220	180	1.200	220,4	295	150	20	125	21035	2123	1426	283	128
FM 250	280	1.200	250,4	345	160	25	125	37883	3279	2196	410	175
FM 280	360	1.200	280,4	375	190	30	125	55210	5498	2945	578	215
FM 280 R	420	1.200	280,4	395	190	30	125	69230	6642	3505	700	245

Material: UNI Fe 510 C – DIN St 52.3

The profiles can be cut on request of the customer, maximum length is 10 m.